

**Gasb 34 Footages for Historical Cost  
Drain Length Log**

Drain-Improvement: WILLIAM P. BENNETT - ASA WILES ARM

Drain Type:	Size:	Length ( )	Length (DB Query)	Length Reconcile	Price:	Cost:
TILE - MAIN	10"	1000'	1000'		3. <sup>00</sup> /lf	3000. <sup>00</sup>
	12"	1300'	1300'		4. <sup>00</sup> /lf	5200. <sup>00</sup>
	10"+12"	1740'x2	1740'x2		3. <sup>00</sup> /lf 4. <sup>00</sup> /lf	12180. <sup>00</sup>
	12"+15"	670'x2	670'x2		4. <sup>00</sup> /lf 5. <sup>00</sup> /lf	6030. <sup>00</sup>
- ARM 1	10"	825'	825'		3. <sup>00</sup> /lf	2475. <sup>00</sup>

Sum: 5535' 5535'

20885.<sup>00</sup>

Final Report: N/A

Comments:  
ALL ABOVE INFO FROM DATA PREVIOUSLY INPUT INTO GIS BY  
SUREE MILLS, DATE UNK/2014

W.P. Bennett

Wm P. Bennett

ASA WILES

Sec. 24 Twp 20 Range 3  
13

LOCATION :

Commencing about 50 rods East of the North West corner of NW quarter Section 24, Township 20 Range 3, thence South 10° East 200 feet thence South 20° east 100 feet thence S 30° E 330 feet thence S 40° E 270 ft. thence S 78° E 300 feet thence E 350 feet thence S 65° 300 feet thence N 60° E 250 feet thence N 69° E 100 feet thence E 100 feet thence S 70° E 100 feet thence S 62° E 700 feet thence S 66° E 700 feet thence S 78° E 650 feet thence S 58° E 150 feet thence S 70° E 150 feet thence N 84° E 80 feet thence N 63° 200 feet thence E 230 feet thence N 50° E 100 feet terminating in the Bennett Ditch about 80 rods South Range 3 E and that the said Ditch be a Tile Ditch as follows.

CR Book 9 page 304, 305, 220, 222, 303, 306 (220 = petition heard & Viewers named. 303 Report approved & Recorded)  
~~Book #2 page 56~~

~~Is now Wiles and Hershman now Marion blanton~~  
order to View = 1894

WDR -- DB 2 p 183  
~~285-286~~

~~DB 1 p. 285~~  
DR 4 p 306 / 306 ← on cash p. E  
38 21

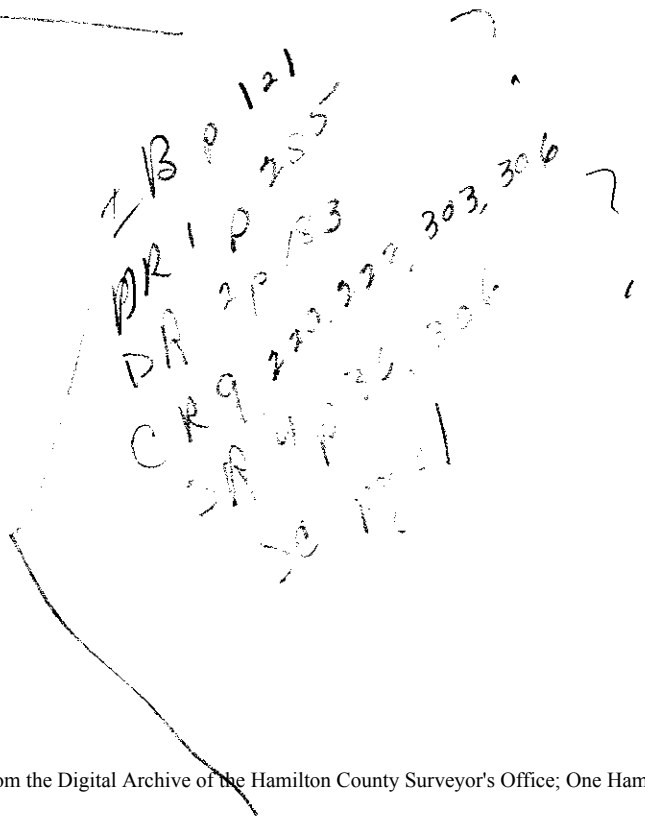

8/20/01 - SW  
Main Tile = 47+10  
ARM 1 = 8125  

---

5535 FEET

\* Constructed 1894

In the Matter of the  
Strawtown and Omega Free  
Gravel Road by  
S W Bray Supt

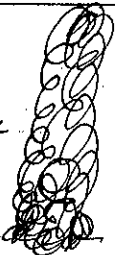

Comes now S W Bray Supt of Construction of the  
Strawtown and Omega Free Gravel Road and files his  
final Report of Construction and Expense for building said  
Free Gravel Road in the following words and figures to wit  
(Here Insert Report) (on file)

and also files this Report including the report of J S Cagner  
Engineer accepting the same as in accord with the  
Specifications and Profile -

And the Board having examined said reports and  
after carefully examining the same and being sufficiently  
advised in the premises do approve said report  
and direct the said Strawtown and Omega Free Gravel  
to be accepted and the same to be kept in repair  
as other Free Gravel Roads of Hamilton County are  
kept and repaired

In the Matter of  
the Report of Viewers  
of Asa Wiles Ditch



Orders issued for final Report Dec 20  
Report of Viewers 94

To the Honorable Board of Commissioners Hamilton Co  
We the Undersigned appointed by this Court at its October  
Special 1894 to view a drain described in the Copy of Petition  
and Order of Court for a Ditch by Asa Wiles and others  
banded us by the Auditor would represent that  
according to said Order we on the day named to wit  
the 12<sup>th</sup> day of November 1894 with J S Cagner an Engineer  
made an accurate survey of the line of proposed Ditch  
from its source to its outlet a plot of said Ditch is filed  
herewith including the survey made by the Engineer and  
marked Exhibit (B) we caused stakes to be set along  
said line each one hundred feet numbering downstream  
as shown by the Plat We also made a computation of the  
total number of cubic yards of earth to be removed  
from said drain and estimated the total cost for the  
Construction of the work at \$858<sup>40</sup>/<sub>100</sub> we also appointed  
and set apart to each parcel of land a share of said

work in proportion to the Benefits received all of which will appear in a tabular statement in this report. We have also set out by a statement below the names of the Owners of the Land Benefited with a description of each tract of Land and the amount assessed against each tract of Land the depth of Cut width at Top and Bottom along said Drain is also shown in this report. After a full and careful view we are of the Opinion that the Drain as located will be of Public Benefit and will benefit 2 Highways and that said Drain can be constructed less than the aggregate benefits to lands affected thereby we do determine that the Method of Drainage should be as follows

The following statement shows who are Benefited the amount thereof and assessments thereon length of each shore amount of assessments and Benefits amount of dirt to be removed & the total Cost thereof

Commencing about 50 rods East of the North West corner of NW 1/4 Sec 24 Town 20 Range 3 thence South 10° East 200 feet thence South 20° East 100 feet thence S 30° E ~~200~~<sup>330</sup> feet thence S 40° E 200 feet thence S 78° E 300 feet thence E 350 feet thence S 65° - 300 feet  
 " " N 60° E 250 " " " N 69° E 100 feet thence E 100 "  
 " " S 70° E 100 " " " S 62° E 700 " " " S 66° E 700 feet  
 " " S 78° E 650 " " " S 58° E 150 " " " S 70° E 150 "  
 " " N 84° E 80 " " " N 63° 200 " " " E 230 "  
 " " N 50° E 100 " terminating in the Bennett ditch about

80 Rods South Range 3 E and that the said ditch be a Tile Ditch as follows. Station 0 to Station 10 1 Row 10 inch Tile.

Station 10 to Station 23 1 Row 12 inch Tile  
 " " 23 " " " 40x40 1 Row 10 inch Tile 1 Row 12 inch Tile  
 " " 40x40 " " 47x10 1 Row 12 " " " 1 Row 15 inch Tile

Also see Aron or Branch Commencing 1 Rod West and 1 Rod North of the NE corner of the NW 1/4. Sec 24 Town 20 N R 3 E thence S 825 feet and terminating in the Main Ditch about 20 feet East of Station 23. the Branch to be a Tile Ditch 1 Row of 10 inch Tile

The length of Main Ditch 4710 feet length of Branch 825 feet  
 The fall of Established Grade from Stat 0 to 40 - 2% to each 100 feet

" " " " " " " " " 40x to 47x10 <sup>25</sup> 100 " " " "  
 Branch from Station 0 to 8x25 3% to each 100 feet Total fall 898 feet

We think the cost of construction of Branch on Aron No 1 as in the petition asked would cost an amount greater than the Benefits received said branch being and running its whole length through Timber Lands and in lieu of said Aron No One We locate a Span or Aron at station 10 on Main line of said ditch and running thence in a southeasterly direction 5 rods until it intersects the lands of Asa Wiles the petitioner said Wiles to construct said Span at his own costs but said Span to be a part of the Ditch herein located and to be constructed

Names of Owners	Description of Lands	Section	Town	Range	Acres	Amount	Acres	Benefit	Amount of Benefit	Amount of Aron	From Station	To Station	Foot Long	Wide	Price	Cost of Construction	Price
Asa Wiles	NW NE	24	20	3	40	34	102	00									
Same	SW NE	24	20	3	40	40	120	00									
Same	SE NE	24	20	3	40	40	120	00									
Same	SW SE	24	20	3	40	40	70	00									
At 70 R. E. 85. R. N. 50 325 S. 120 to beginning	SW NE	24	20	3	61	61	183	00	595	00	10725	38792	2777	774			510
to Mc Philips Com	SW NE	24	20	3	9	9	27	00	27	00	0	2x57	257	23	amtd		23
Com 40 R. E. NW	SW NE	24	20	3	20	20	60	00			10725	1025	100				85
Com 40 R. E. NW	SW NE	13	20	3	40	20	40	00	100	00	0						
Com SE Com NW	SW NE	24	20	3													
Asanonda Bago	SW NE	24	20	3	30	25	35	00	35	00	4353	4464	111	13			30
D S Colvin	NE SW	24	20	3	40	40	25	00			44	45					
Same	SE SW	24	20	3	40	30	15	00	40	00	44	45	129	14			34
Mc Myers	NW SW	24	20	3	40	22	10	00	10	00	45	46	33	4			8
S M Myers	NW SW	24	20	3	20	10	10	00			46	46					
Same	SE SW	24	20	3	10	10	10	00	20	00	46	47	64	8			17
Catherine Bennett	NE SE	24	20	3	40	20	20	00	30	00	46	47	20				25
Maria Wilson	SE SW	13	20	3	10	10	20	00	20	00	42	43	64	8			17
Polly Philips	NE SW	13	20	3	30	20	30	00	30	00	41	42	96	12			25
J D Philips	SE SW	13	20	3	20	12	18	00	18	00	41	41	58	6			15
Fred Ginter	SE SE	14	20	3	40	8	7	50	7	50	41	41	24	3			6
Wm Booth	NE NE	23	20	3	40	12	15	00	55	00	38	41	218	60			47
Hamilton County	GR	24	20	3					5	00	2x57	3x5	48	7			429
Adams Tomlin	NE	24	20	3					8	00	3x5	3x70	65	8			686

Over

Specifications

All Tile to be well burned of uniform color to be laid in the Ditch to an established grade in a true line well matched together and when laid in the Ditch to form the truest line of pipes possible no earth to be thrown on Tile until received by Engineer after which all earth taken from said Ditch shall be put back.

There shall be a wall built of Bouleaux at the terminus of main Ditch as follows: 3 feet wide in Bottom 9 ft wide in top 3 feet thick in Bottom and 18 inches at the top and to have ~~2 foot~~ a Batter of 2 inches to the foot on the outside said Wall to be laid with Cement mixed 2 parts of Sand 1 Part Cement a large flat rock to be used on Top as Capping also said Wall to be neatly fit around the Tile said Wall to commence 6 inches below grade of Tile

Eli Brooks, G. W. Wheeler Hamilton Metzger

Station	Top of Cut	Width of Top	Width of Bottom	Depth of Trench	Cost of Cement	Profile Main Ditch	Station	Depth of Cut	Width of Top	Width of Bottom	Side Slope	Cost
0	3.62	18 in	15 in	15			19	3.96	18	15	14	15
B.M. 420		White Oak	E	S of Ditch			B.M. 561		Reach 15 feet North of Station 19			
1	4.68	18 in	15	8	8 10	Station 9 to 10 1 Row 10 inch Tile	20	4.36	18	15	14	1
2	4.81	-	-	8	8 10		21	4.39	"	"	14	1
3	3.86	-	-	8	8 10		22	4.80	"	"	14	1
4	4.15	-	-	8	8 10		23	3.31	30 in	30	35	1
5	3.03	-	-	8	8 10		24	4.01	-	-	35	1
6	3.38	-	-	8	8 10		25	4.66	-	-	37	2
7	2.49	-	-	8	8 10		26	4.21	-	-	37	2
8	3.18	-	-	8	8 10		27	4.60	-	-	37	2
9	3.29	-	-	8	8 10		28	4.66	-	-	37	2
10	3.70	-	-	20	10 00		29	4.60	-	-	37	2
B.M. 404		Edin 15 ft	N of Ditch	10		Station 10 to Station 23 1 Row 12 inch Tile	30	4.52	-	-	37	2
11	3.84	-	-	20	11 90		B.M. 587		Reach 100 feet North of Station 10			
12	4.29	-	-	20	11 90		31	3.52	30	30	33	1
13	4.81	-	-	20	11 90		32	3.81	-	-	33	1
14	4.80	-	-	20	11 90		33	3.57	-	-	33	1
15	4.15	-	-	15	11 15		34	3.57	-	-	33	1
16	4.24	-	-	14	11 00		35	3.93	-	-	33	1
17	4.36	-	-	14	11 00		36	3.82	-	-	33	1
18	4.98	-	-	14	11 00	37	3.35	-	-	33	1	

Station	Height of Cut	Width Top	Width Bottom	Side Slope	Price	Profile of Main Ditch	Profile of Arms No 1	Station	Height of Cut	Width Top	Width Bottom	Side Slope	Price	Cost of Material
38	3.73	30	30	33	15	19 65		0	4.15	15m	14m	14	15	
39	3.77	"	"	33	-	19 65		B.M. 425	Side Culvert	15m	14m	14	15	9 00
B.M. 402						Bottom cut south of ditch		1	4.95	-	-	14	-	9 00
40	3.17	"	"	33	-	19 65		2	4.20	-	-	14	-	9 00
41	4.00	3 feet	3 feet	25	-	23 36	End of 12 End 10 inch tile	3	3.60	-	-	14	-	9 00
42	3.88	"	"	12		26 70		4	3.61	-	-	14	-	9 00
43	4.40	"	"	12		26 70		5	3.65	-	-	14	-	9 00
44	4.15	"	"	12		26 70		6	3.75	-	-	14	-	9 00
45	3.75	"	"	12		26 70		7	3.50	-	-	14	-	9 00
46	3.93	"	"	12		26 70		8	3.75	-	-	14	-	9 00
47	3.30	"	"	12		26 70		9	4.00	-	-	14	-	9 00
48						3 25		10	4.00	-	-	14	-	21 65
49						20 00								74 65
						464 45								
						319 30								
						74 65								
						858 40								

The Board having Examined the Report of Viewers and  
 And Notice given and these being as Remonstrance filed  
 in accordance to Law and the Board being  
 sufficiently advised in the Premises do approve  
 said report and Order the same Constructed  
 in accordance with the Law

In the Matter of *Final Report*  
 the Report of Viewers *Approved Nov 20 1894*  
 Mary E Wilson Ditch *Report of Viewers*

To the Honorable Board of Commissioners of Hamilton County  
 Indiana: We the undersigned, appointed by this Court at its  
 Term, 18, to view a drain described in the certified copy  
 of a petition and order of Court for a Ditch by Mary E Wilson  
 and others, handed us by the Auditor, would represent that  
 according to said order we, on the day named therein, to wit:  
 the 1<sup>st</sup> day of November, 1894, in company with J. S. Coryne  
 a civil engineer, made an accurate survey of the line of  
 said proposed Ditch, from its source to its outlet, a  
 plat of said Ditch is filed herewith including the  
 survey by the engineer, marked "Exhibit. B." We caused  
 stakes to be set along said line, each one hundred feet,